

# PLS1



## PACIFIC LASER SYSTEMS

The Professional Standard

### FEATURES

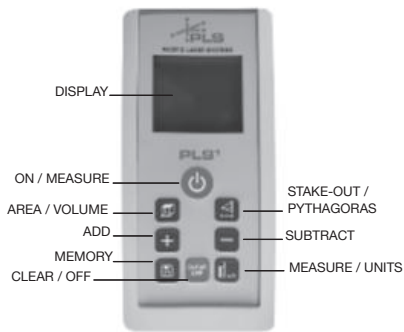

### INSERT BATTERIES



To ensure a reliable use, do not use zinc-carbon batteries. Change batteries when battery symbol is flashing.

### MULTIFUNCTIONAL ENDPIECE

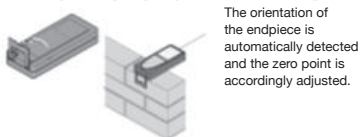

The orientation of the endpiece is automatically detected and the zero point is accordingly adjusted.

### MENU SWITCH



#### KEY DESCRIPTION

	Short Key press: Switch on / Laser on / Measure
	1x press = add + / increase 1x press = subtract - / decrease
	1x key press = area 2x key press = volume
	1x press = stake out only with 1 value 2x press = Pythagoras 1 3x press = Pythagoras 2 4x press = Pythagoras 3
	default = measure from back of device 1x press = measure from front 2x press = measure from tripod screw => (tripod symbol)  Measure from endpiece is automatically detected Press for 2sec to change unit
	1x press = memory of 10 displays press this key for 2sec = take main value for further calculations
	1x press = step back or clear last value 2x press = clear all  as usual - press for 2sec to turn off

#### DISTANCE UNIT SETTING

2 sec

	Switch between the following units:
0.0000m	0.00 ft.
0.000m	0.00 1/32
0.00m	0.00 in.
	0 1/32

### SAFETY INSTRUCTIONS

#### ELECTROMAGNETIC COMPATIBILITY

**WARNING**  
This equipment has been tested and found to comply with the limits for a Class B digital device, pursuant to part 15 of the FCC Rules.

#### LASER CLASSIFICATION

The device produces visible laser beams which are emitted from the instrument: It is a Class 2 laser product in accordance with:  
• IEC60825-1; "2007 Radiation safety of laser products"

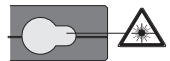

#### Laser Class 2 products:

Do not stare into the laser beam or direct it towards other people unnecessarily. Eye protection is normally afforded by aversion responses including the blink reflex.

#### WARNING

Looking directly into the beam with optical aids (e.g. binoculars, telescopes) can be hazardous.

#### CAUTION

Looking into the laser beam may be hazardous to the eyes.

#### LABELLING



Subject to change (drawings, descriptions and technical data) without prior notice.

### SAFETY INSTRUCTIONS

The person responsible for the instrument must ensure that all users understand these directions and adhere to them.

#### Areas of responsibility

Responsibilities of the manufacturer of the original equipment:

PLS · Pacific Laser Systems  
2500 Kerner Blvd.  
San Rafael, CA 949401

The company above is responsible for supplying the product, including the User Manual in a completely safe condition. The company above is not responsible for third party accessories.

#### Responsibilities of the person in charge of the instrument:

- To understand the safety instructions on the product and the instructions in the User Manual.
- To be familiar with local safety regulations relating to accident prevention.
- Always prevent access to the product by unauthorized personnel

#### Permitted use

- Measuring distances
- Tilt measurement

#### Prohibited use

- Using the product without instruction
- Using outside the stated limits
- Deactivation of safety systems and removal of explanatory and hazard labels
- Opening of the equipment by using tools (screwdrivers, etc.)
- Carrying out modification or conversion of the product
- Use of accessories from other manufacturers without express approval
- Deliberate dazzling of third parties; also in the dark
- Inadequate safeguards at the surveying site (e.g. when measuring on roads, construction sites, etc.)
- Deliberate or irresponsible behavior on scaffolding, when using ladders, when measuring near machines which are running or near parts of machines or installations which are unprotected
- Aiming directly in the sun

### SAFETY INSTRUCTIONS

#### Hazards in use

**WARNING**  
Watch out for erroneous measurements if the instrument is defective or if it has been dropped or has been misused or modified. Carry out periodic test measurements, particularly after the instrument has been subject to abnormal use, and before, during and after important measurements.

**CAUTION**  
Never attempt to repair the product yourself. In case of damage, contact a local dealer.

**WARNING**  
Changes or modifications not expressly approved could void the user's authority to operate the equipment.

**Limits of use**  
Refer to section "Technical data". The device is designed for use in areas permanently habitable by humans. Do not use the product in explosion hazardous areas or in aggressive environments.

**Disposal**  
**CAUTION**  
Flat batteries must not be disposed of with household waste. Care for the environment and take them to the collection points provided in accordance with national or local regulations. The product must not be disposed with household waste. Dispose of the product appropriately in accordance with the national regulations in force in your country. Adhere to the national and country specific regulations. Product specific treatment and waste management can be downloaded from our homepage.



### MESSAGE CODES

If the message Error does not disappear after switching on the device repeatedly, contact the dealer. If the message InFo appears with a number, press the Clear button and observe the following instructions:

Cause	Correction
204	Calculation error Perform measurement again.
252	Temperature too high Let device cool down.
253	Temperature too low Warm device up.
255	Received signal too weak, measuring time too long Change target surface (e.g. white paper).
256	Received signal too high Change target surface (e.g. white paper).
257	Too much background light Shadow target area.
258	Measurement outside of measuring range Correct range.
260	Laser beam interrupted Repeat measurement.

### CARE

- Clean the device with a damp, soft cloth.
- Never immerse the device in water.
- Never use aggressive cleaning agents or solvents.

### TECHNICAL DATA

Distance measurement	
Typical Range*	0.05-80 m / 2-265 ft
Range at unfavourable condition ***	60 m / 197 ft
Measuring Accuracy **	+/- 1.5 mm / 1/16 in
General	
Laser class	2
Laser type	635 nm, < 1 mW
Protection class	IP54 (dust- and splash water)
Autom. laser switch off	after 90 seconds
Autom. power switch-off	after 180 seconds
Battery durability (2 x AAA)	up to 3000 measurements
Dimension (H x D x W)	120 x 58 x 29 mm (4.7 x 2.3 x 1.2 in.)
Weight (with batteries)	146 g / 4.98 oz
Temperature range:	
- Storage	-25 to 70 °C -13 to 158 °F
- Operation	-10 to 50 °C 14 to 122 °F

### TECHNICAL DATA

Functions	
Distance measuring	yes
Min/Max measuring	yes
Permanent measuring	yes
Stake-out	yes
Addition/Subtraction	yes
Area	yes
Volume	yes
Pythagoras	3-point, partial height
Memory	10 displays
Beep	yes
Illuminated display	yes
Multifunctional endpiece	yes

\* applies for 100 % target reflectivity (white painted wall), low background illumination, 25 °C  
\*\* Tolerances apply from 0.05 m to 10 m with a confidence level of 95%. The maximum tolerance may deteriorate to 0.1 mm/m between 10 m to 30 m and to 0.20 mm/m for distances above 30 m  
\*\*\* applies for 100 % target reflectivity, background illumination of approximately 30'000 lux

For accurate indirect results, the use of a tripod is recommended. For accurate tilt measurements a transverse tilt should be avoided.

Target surfaces: Measuring errors can occur when measuring to colorless liquids, glass, styrofoam or semi-permeable surfaces or when aiming at high gloss surfaces. Against dark surfaces the measuring time increases.

### WARRANTY

This product is warranted by PLS · Pacific Laser Systems to the original purchaser to be free from defects in material and workmanship under normal use for a period of two years from the date of purchase. During the warranty period, and upon proof of purchase, the product will be repaired or replaced (with the same or similar model at our option), without charge for either parts or labor, through PLS. The purchaser shall bear all shipping, packing and insurance costs. Upon completion of the repair or replacement, the unit will be returned to the customer, freight prepaid. The warranty will not apply to this product if it has been misused, abused or altered. Without limiting the foregoing, battery leakage, dents or gouges to the plastic housing, broken optic windows, damage to the switch/LED membrane are presumed to result from misuse or abuse. Tampering with or removal of the caution or certification labels voids this warranty.

Neither this warranty nor any other warranty, express or implied, including implied warranties of merchantability, shall extend beyond the warranty period. No responsibility is assumed for any incidental or consequential damages. This warranty gives you specific legal rights, and you may have other rights which vary from state to state.

## SWITCHING ON/OFF

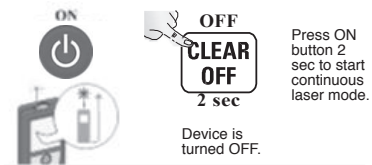

## CLEAR

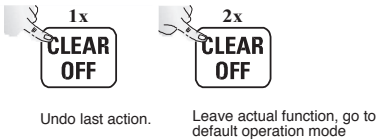

## MESSAGE CODE

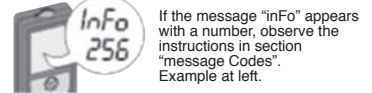

## ADJUSTING MEASURING REFERENCE / TRIPOD

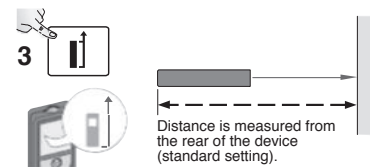
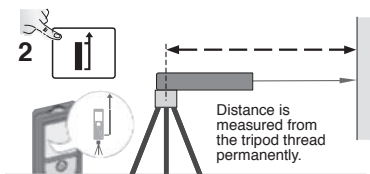
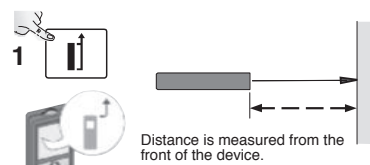

## BEEP ON/OFF



## ILLUMINATION ON/OFF



## ADD / SUBTRACT

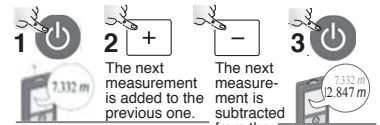

The result is shown in the main line and the measured value above. This process can be repeated as required. The same process can be used for adding or subtracting areas or volumes.

## MEASURING SINGLE DISTANCE

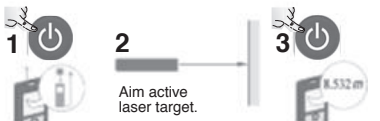

## PERMANENT / MINIMUM-MAXIMUM MEASURING

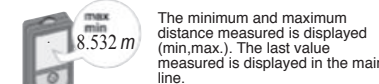
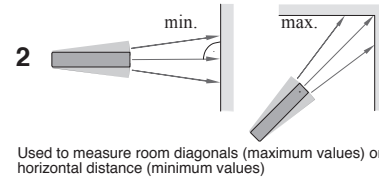

## MEMORY (10 LAST DISPLAYS)

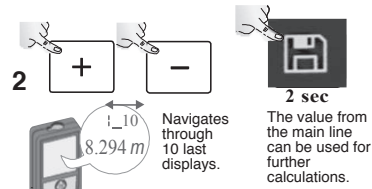
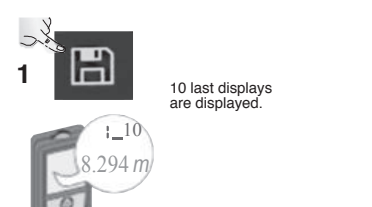

## DELETE MEMORY



## AREA

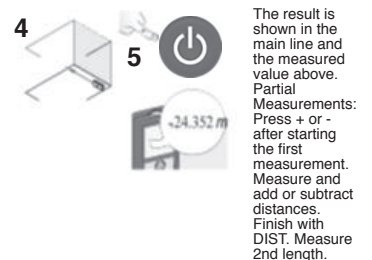
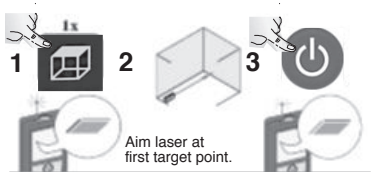

Press 2 sec AREA / VOLUME key to get 2nd results.

## VOLUME

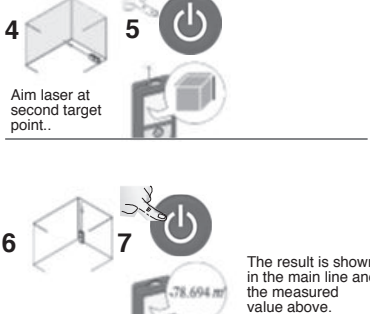
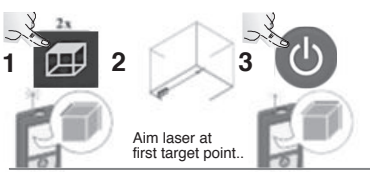

Press 2 sec AREA / VOLUME key to get 2nd results.

## PYTHAGORAS (3-POINT)

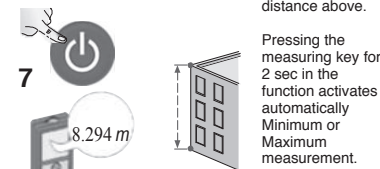
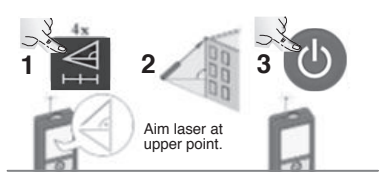

## PYTHAGORAS (PARTIAL HEIGHT)

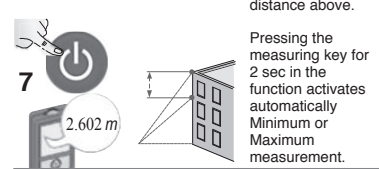
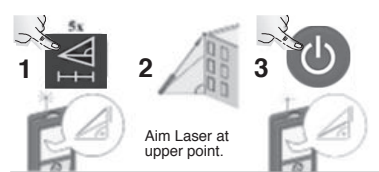

## STAKE OUT

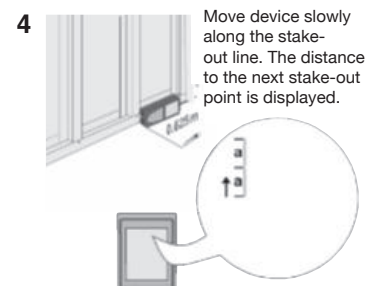
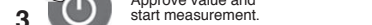
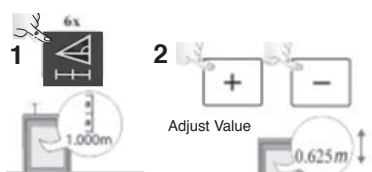

When approaching a stake out point to less than 0.1 m the instrument starts to beep. The function can be stopped by pressing the CLEAR/OFF button.